

# TIVOLI

ORIENTE  
LISBOA  
CONFERENCE HOTEL

★ ★ ★ ★



With a privileged location in Parque das Nações, next to Oriente Station, the Tivoli Oriente will surprise guests with its recent remodelling project which has given new energy to the different areas of the hotel. Today, in the most dynamic business and residential area of modern Lisbon, the hotel provides guests with great quality service for both business and leisure travellers.

See the hotel's video [here](#).

## LOCATION

It is located in Parque das Nações in Lisbon, 3km from Lisbon Airport. GPS : N 38° 45' 59,67", O 9° 05' 52,76".

## ACCOMMODATION

279 Rooms with Queen Size or Twin beds, including:

- 2 Executive Suite – River View
- 6 Junior Suite – River View
- 8 Junior Suite– Avenue View
- 1 Junior Suite – City View
- 2 Superior Family Room – River View
- 6 Superior Family Room – Avenue View
- 58 Superior Room – River View
- 80 Superior Room – Avenue View
- 116 Superior Room – City View
- 1 Superior Room – City View especially adapted for disabled guests

## EXECUTIVE SUITE

These suites of around 60 m2 are located on the top floors of the hotel - 14 and 15. With views of the fabulous River Tagus and contemporary decoration they have a room with double bed, a living room, a dining room as well as 2 fully equipped bathrooms with shower and bath tub. Guests also have a Nespresso coffee machine.

## JUNIOR SUITE – RIVER VIEW

These suites of around 40 m2 have views of the fabulous River Tagus and are located on floors 10 to 15 of the hotel. They have a bedroom with double bed and an independent living area with two sofas and a centre table, contemporary decoration and a fully equipped bathroom with shower or bath tub. Guests also have a Nespresso coffee machine.

## JUNIOR SUITE– AVENUE VIEW

These suites of around 40 m2 have views of the main avenue of Parque das Nações. They have a bedroom with double bed located on floors 4 to 9 of the hotel or a bedroom with twin beds located on floor 2 of the hotel, and an independent living area with two sofas and a centre table, contemporary decoration and a fully equipped bathroom with shower. Guests also have a Nespresso coffee machine.

## JUNIOR SUITE – CITY VIEW

This suite of around 40 m2 is located on floor 3 of the hotel and has a view of the city of Lisbon. It has a bedroom with a double bed and an independent living area with two sofas and a centre table. Decoration is contemporary and there are also two fully equipped bathrooms with shower. Guests also have a Nespresso coffee machine.

## SUPERIOR FAMILY ROOM – RIVER VIEW

These rooms offer views of the fabulous River Tagus and have twin beds and a single sofa bed. With an area of around 20 m2 and contemporary decoration, they are located on floors 10 and 11 of the hotel. They also have work area with a desk and chair and a fully equipped bathroom with shower. Guests also have a Nespresso coffee machine.

WORLDHOTELS  
first class



## Tivoli Oriente

Tivoli Oriente  
Av. Dom João II - Nº27  
Parque das Nações  
1990-083 Lisboa - Portugal  
T. +351 218 915 100 · F. +351 218 915 345  
[reservations@tivolihotels.com](mailto:reservations@tivolihotels.com)  
[www.tivolioriente.com](http://www.tivolioriente.com)

# TIVOLI

ORIENTE  
LISBOA  
CONFERENCE HOTEL

★ ★ ★ ★



## SUPERIOR FAMILY ROOM – AVENUE VIEW

These rooms with an area of around 20 m2 and contemporary decoration have twin beds and a single sofa bed. With views of the main avenue of Parque das Nações, they are located from floors 4 to 9 of the hotel. They also have work area with a desk and chair and a fully equipped bathroom with shower. Guests also have a Nespresso coffee machine.

## SUPERIOR ROOM – RIVER VIEW

These rooms have views of the fabulous River Tagus and are located on floors 10 to 15 of the hotel. With an area between 18m2 and 20 m2 and contemporary decoration, they have double bed, twin beds or single bed, work area with a desk and chair and a fully equipped bathroom with shower or bath tub. Guests also have a Nespresso coffee machine.

## SUPERIOR ROOM – AVENUE VIEW

These rooms with an area between 18m2 and 20 m2 are located on floors 2 to 9 of the hotel and have views of the main avenue of Parque das Nações. With contemporary decoration, they have double bed, twin beds or single bed, work area with a desk and chair and a fully equipped bathroom with shower. Guests also have a Nespresso coffee machine.

## SUPERIOR ROOM – CITY VIEW

These rooms with an area between 18m2 and 20 m2 are located on floors 2 to 15 of the hotel and have a view of the city of Lisbon. With contemporary decoration, they have double bed, twin beds or single bed, work area with a desk and chair and a fully equipped bathroom with shower or bath tub. Guests also have a Nespresso coffee machine.

### Rooms equipped with:

- Individual Air Conditioning
- Direct Telephone
- Mini-bar
- LCD TV
- Wireless Internet
- Sofa and individual armchair
- Shower or bath tub
- Safe
- Nespresso Coffee Machine
- Hair drier
- Magnifying mirror
- Tivoli Hotels & Resorts Toiletries

### Suites equipped with:

- Individual Air Conditioning
- Direct Telephone
- Mini-bar
- LCD TV
- Wireless Internet
- Living area with two sofas and a centre table
- Shower or bath tub
- Safe
- Nespresso Coffee Machine
- Hair drier
- Magnifying mirror
- Tivoli Hotels & Resorts Toiletries

### HOTEL SERVICES

- Paid parking
- 24 hour Room Service
- Laundry Service
- Video-on-demand
- Non-smoking rooms and public areas
- Team of Experience Assistants available 24 hours
- Ticket and excursion reservations
- Kits for kids and young people
- Rent-a-car: Europcar

### LEISURE SERVICES

- Heated indoor swimming pool
- Free Fitness Centre

WORLDHOTELS  
first class



### Tivoli Oriente

Tivoli Oriente  
Av. Dom João II - N.º27  
Parque das Nações  
1990-083 Lisboa - Portugal  
T. +351 218 915 100 · F. +351 218 915 345  
reservations@tivolihotels.com  
[www.tivoloriente.com](http://www.tivoloriente.com)

# TIVOLI

ORIENTE  
LISBOA  
CONFERENCE HOTEL

★ ★ ★ ★



- Jacuzzi
- Steam Room

- Sauna

## BUSINESS CENTRE SERVICES

- Free 24 Hour Access to Business Centre
- Access to printer, scanner and basic office service
- 3 Work stations with free Internet access
- Selection of Portuguese and foreign newspapers

## SUMMARY OF ROOMS AND SUITES

Type of Room	Nº	Área	Type of Bed	Floors
Superior Room – City View	116	18m <sup>2</sup> to 20m <sup>2</sup>	76 Rooms with double bed 39 Rooms with twin beds 1 Rooms with single bed	2º - 15º
Superior Room – Avenue View	80	18m <sup>2</sup> to 20m <sup>2</sup>	51 Rooms with double bed 22 Rooms with twin beds 7 Rooms with single bed	2º - 9º
Superior Room – River View	58	18m <sup>2</sup> to 20m <sup>2</sup>	30 Rooms with double bed 22 Rooms with twin beds 6 Rooms with single bed	10º - 15º
Superior Family Room – Avenue View	6	20m <sup>2</sup>	6 Rooms with twin beds	4º - 9º
Superior Family Room – River View	2	20m <sup>2</sup>	2 Rooms with twin beds	10º; 11º
Junior Suite – City View	1	40m <sup>2</sup>	1 Suite with double bed	3º
Junior Suite – Avenue View	8	40m <sup>2</sup>	7 Suites with double bed 1 Suite with twin bed	4º - 9º 2º
Junior Suite – River View	6	40m <sup>2</sup>	6 Suites with double bed	10º - 15º
Executive Suite – River View	2	60m <sup>2</sup>	2 Suites with double bed	14º; 15º

## HOTEL POLICIES

### Check-in and Early check-in

Check-in time is from 14:00 onwards. An early check-in is available, subject to a surcharge: if it occurs before 10:00, the previous night's full room rate will be charged; if check in occurs after 10:00 and before 14:00, a surcharge equivalent to 50% of the previous night's room rate will be applied.

### Check-out and Late check-out

Check-out is until 12:00. Late check-out is available subject to a surcharge: If you check out between 12:00 and 16:00, the equivalent to 50% of the following night's room rate will be charged. If you check-out after 16:00, that day's full room rate will be charged.

### Cancellation Policy

For cancellations and no-shows, the reservation will be subject to a debit in accordance with the information provided at the point of reservation.

WORLDHOTELS  
first class



### Tivoli Oriente

Tivoli Oriente  
Av. Dom João II - Nº27  
Parque das Nações  
1990-083 Lisboa - Portugal  
T. +351 218 915 100 · F. +351 218 915 345  
reservations@tivolihotels.com  
[www.tivoloriente.com](http://www.tivoloriente.com)

# TIVOLI

ORIENTE  
LISBOA  
CONFERENCE HOTEL



## RESTAURANTS & BARS

### Hippopotamus Restaurant

With relaxed decoration and a family atmosphere, the Hippopotamus is now *the* place to meet for anyone looking to enjoy the best in grilled meat, done to perfection. Located on the ground floor and with direct access to outside, it is ideal for a quick lunch or relaxing dinner with the family or friends. The fun mascot – Hippo – present throughout the restaurant and on the play packs ensures that children are well entertained and enjoy their food. It seats up to 180 people. Open every day of the week from 12.30 to 24.00.

### Tivoli Caffè Oriente

Located on the 1<sup>st</sup> floor of the hotel with a cosmopolitan decoration, this bar has a great view of the award winning Oriente Station and is the ideal spot for an informal meeting or late afternoon or early evening drink with friends. Open every day from 09.00 to 01.00

## LEISURE, ENTERTAINMENT AND SPORTS

- Lisbon Oceanarium – 300 metres
- Lisbon Casino - 5 min. walk
- Cinema – in the Vasco da Gama Shopping Centre
- St. Jorge's Castle – by bus
- Shops – right opposite (Shopping Centre)
- Atlântico Multi-Purpose Pavilion – 5 min. walk
- Beach – 30 min.
- Downtown – by metro
- Golf – 25 min.
- Night Clubs – 15 min.

## CONFERENCES AND MEETINGS AT THE TIVOLI ORIENTE

With a total area of 1,200m<sup>2</sup>, the events area at the Tivoli Oriente is equipped with the most recent audiovisual technology and lighting. We have a total of 12 rooms ranging in areas from 20 m<sup>2</sup> to 348 m<sup>2</sup>, holding up to 550 cocktail.

### Support Infrastructures

- 12 Rooms equipped with the latest technology
- Reception facilities for groups

### Services Available:

- WI-FI in public areas and meeting rooms
- Analogue line and ISDN in rooms
- Business Centre with free ADSL line

WORLDHOTELS  
first class



### Tivoli Oriente

Tivoli Oriente  
Av. Dom João II - Nº27  
Parque das Nações  
1990-083 Lisboa - Portugal  
T. +351 218 915 100 · F. +351 218 915 345  
reservations@tivolihotels.com  
[www.tivoloriente.com](http://www.tivoloriente.com)



# TIVOLI

ORIENTE  
LISBOA  
CONFERENCE HOTEL

★ ★ ★ ★



Rooms	W x L x H	Area	Banquet	Cocktail	School	Theatre	U Table	Cabaret
Alcântara	7,33 x 7,8 x 3	68,3 m <sup>2</sup>	40	-	30	40	20	20
Alfama	8 x 7,5 x 3	73,1 m <sup>2</sup>	50	-	32	45	24	25
Chiado	8 x 7,5 x 3	73,1 m <sup>2</sup>	50	-	32	45	24	25
Castelo	7,7 x 7,6 x 3	58 m <sup>2</sup>	30	-	26	40	20	15
Campolide	9,7 x 7,2 x 3	68 m <sup>2</sup>	40	-	34	50	26	20
Olivais	11,8 x 5,9 x 3	81,5 m <sup>2</sup>	40	-	34	50	20	20
Graça	6,4 x 4,3 x 3	27 m <sup>2</sup>	-	-	12	16	15	-
Madredeus	6,4 x 4,3 x 3	27 m <sup>2</sup>	-	-	12	16	15	-
Madragoa	4,91 x 4,2 x 3	20 m <sup>2</sup>	10	-	-	12	11	5
Marvila	4,8 x 7 x 3	41,5 m <sup>2</sup>	30	-	22	30	22	15
Lapa	5,5 x 10,3 x 3	51,4 m <sup>2</sup>	30	-	24	36	24	15
Lisboa Antiga*	-	348 m <sup>2</sup>	280	550	210	400	-	140
Oriente**	-	250 m <sup>2</sup>	160	300	130	230	50	130
VIII Colina Sala Panorâmica no 16º piso	-	210 m <sup>2</sup>	120	200	70	130	65	75

\*Lisboa Antiga (Alcântara+Alfama+Chiado +Castelo+Campolide+Olivais)

\*\*Oriente (Olivais+Campolide+Castelo)

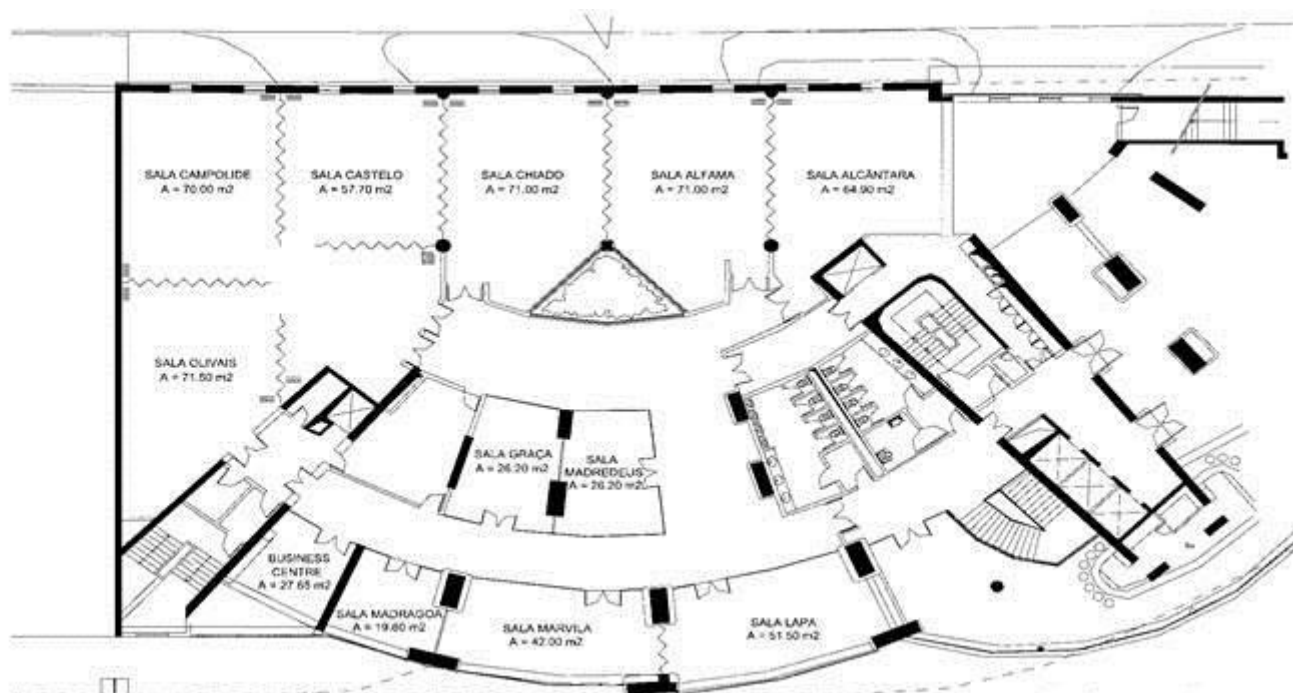

WORLDHOTELS  
first class



Tivoli Oriente

Tivoli Oriente  
Av. Dom João II - Nº27  
Parque das Nações  
1990-083 Lisboa - Portugal  
T. +351 218 915 100 · F. +351 218 915 345  
reservations@tivolihotels.com  
[www.tivoloriente.com](http://www.tivoloriente.com)