

HYATT REGENCY LONDON – THE CHURCHILL

30 Portman Square
London W1H 7BH
United Kingdom

T: +44 (0)20 7486 5800
F: +44 (0)20 7486 1255
E: london.churchill@hyatt.com
london.churchill.hyatt.com



ACCOMMODATION

- 434 well-appointed guestrooms, including 50 suites, 296 king and 88 twin rooms

All Accommodations Offer:

- Wireless and wired high-speed Internet access (Fee)
- 40-inch flat-panel LED Television, with a wide range of international channels and pay-per-view movies
- Spacious work desk
- Dual-line telephone with separate voice mail
- Shower and bath amenities and hair dryer
- In-room safety deposit box
- Tea and coffee making facilities
- Iron and ironing board
- Individual climate control
- Selection of international newspapers on request
- Crib upon request
- Regency Club® rooms and suite located on the 7th, 8th and 9th floors enjoy the Regency Club® Executive and Family lounges

SERVICES AND FACILITIES

- Multi-lingual staff and concierge service
- 24-hour Escape Bar (Business Centre)
- 24-hour in-room dining
- Concierge & Co, our hotel shop
- Valet parking. Parking with 48 indoor spaces
- Tesla Superchargers
- Dry cleaning and laundry

- Dry cleaning and laundry
- Babysitting
- Special needs rooms
- Airport limousine on request

RESTAURANTS AND BARS

- **The Montagu** – A vibrant restaurant to relax and indulge in a wide range of British seasonal dishes, all of which are prepared in a striking open kitchen.
- Afternoon Tea available daily.
- **Locanda Locatelli** – Award-winning Michelin star restaurant offers authentic Italian cuisine.
- **The Churchill Bar and Terrace** – With its own entrance on Portman Square and a dazzling menu of cocktails, The Churchill Bar and its deeply glamorous private terrace offers an enticing space to relax with friends, family and colleagues

MEETING AND EVENT SPACE

- 671 m² / 7262 ft² of flexible event space
- 13 meeting and event rooms including a ballroom and two boardrooms
- Three interconnecting meeting and event rooms
- Natural daylight in six meeting rooms
- Wedding licence

RECREATIONAL FACILITIES

- The Churchill Health Club (open 24 hours)—Offering a variety of cardiovascular exercise machines
- Outdoor floodlit tennis court and jogging track in the private Portman Square garden.

LOCATION

One of the finest 5 star hotels in London, Hyatt Regency London - The Churchill enjoys a prime location in Central London's West End, close to exclusive shopping and the City. Its positioning in the Marylebone area, adjacent to Park Lane, ensures that it is one of the best situated luxury hotels in London from which to explore Hyde Park, Marble Arch and Buckingham Palace, some of London's most celebrated landmarks. The hotel is just two minutes from the nearest tube station, Marble Arch and from the exclusive shopping areas of Oxford Street, Soho or Bond Street.

DIRECTIONS

Hyatt Regency London - The Churchill is easily accessible from London's major airports and is within 10 to 20 minutes, by car, from several of London's train stations. The hotel is 15 minutes from Paddington Station from where the Heathrow Express train connects to Heathrow Airport in just 15 minutes

POINTS OF INTEREST

- London Attractions: Big Ben, Tower of London, The London Eye, The Tate Modern Gallery, Madame Tussaud's
- British Museum; National Gallery; Buckingham Palace
- Houses of Parliament
- St. Paul's Cathedral
- West End shopping and theatres
- Churchill War Rooms

VISITOR INFORMATION

- Language: English
- Currency: British Pound (GBP)
- Voltage: 240 volts
- Climate: London has a pleasant climate with warm summers and mild winters. The temperatures vary from 0°C / 32°F in Winter to 21°C / 70°F in Summer
- Visas: EU / EEA nationals do not require a visa to enter the UK, other nationals should contact the British Consulate

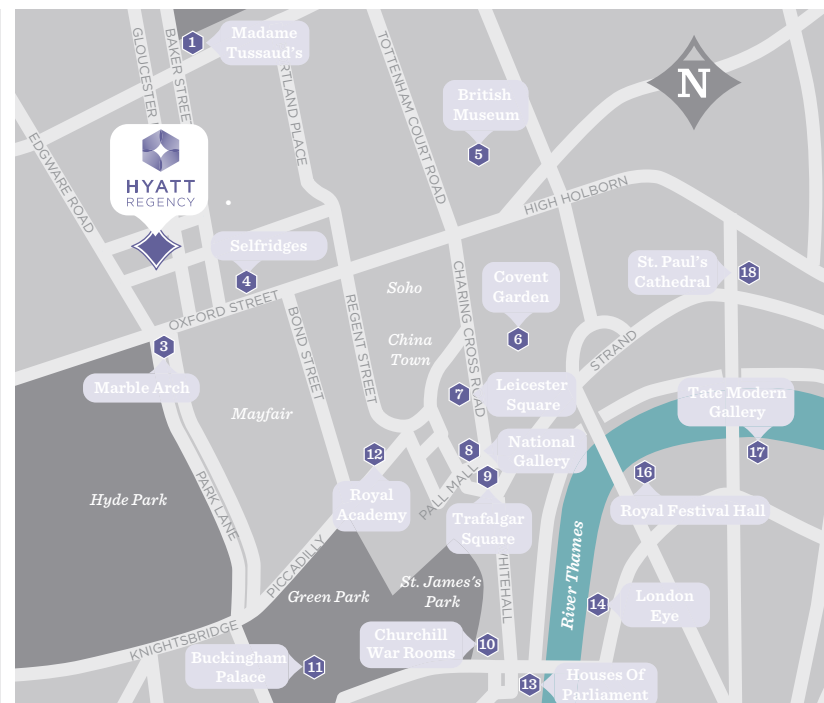

HYATT REGENCY LONDON – THE CHURCHILL

30 Portman Square
London W1H 7BH
United Kingdom

T: +44 (0)20 7486 5800
F: +44 (0)20 7486 1255
E: london.churchill@hyatt.com
london.churchill.hyatt.com



CAPACITY CHART



Room Name	Room Dimensions L x W x H	Room Size Sq. M. / Sq. Ft.	Theatre	Classroom	U-Shape	Boardroom	Banquet	Cocktail	Cabaret
Ground Floor									
CHARTWELL SUITE	17.3m x 14m x 3.6m 57' x 46' x 11.8'	242.2 2622	250	180	68	68	240	350	144
<i>Chartwell I</i>	10.2m x 14m x 3.6m 33.5' x 46' x 11.8'	142.8 1541	144	90	42	36	144	200	80
<i>Chartwell II</i>	7.1m x 14m x 3.6m 23.3' x 46' x 11.8'	99.4 1072	100	63	38	24	96	100	48
THE MONTAGU	22m x 13.5m x 3.6m 72.2' x 42.3' x 11.8'	267.1 2875	—	—	—	—	190	250	—
THE CABINET SUITE	22.2m x 4.9m x 2.3m 72.8' x 16' x 7.5'	108.8 1165	—	—	—	—	100	120	80
<i>Cabinet I</i>	7.1m x 4.9m x 2.3m 23.3' x 16.05' x 7.5'	34.8 374	35	24	18	18	30	40	24
<i>Cabinet II</i>	7.1m x 6m x 2.3m 23.3' x 19.7' x 7.5'	42.6 459	45	28	20	20	40	40	32
<i>Cabinet III</i>	8.0m x 4.9m x 2.3m 26.2' x 16.0' x 7.5'	39 419	45	28	20	20	30	40	24
LIBRARY	9m x 6.9m x 3.4m 29.5' x 22.6' x 11.2'	62.1 667	70	35	28	25	50	120	—
BOARDROOM I	6.7m x 3.5m x 2.1m 22' x 11.5' x 6.9'	23.5 253	—	—	—	—	10	—	—
BOARDROOM II	4.75m x 3.5m x 2.3m 15.6' x 11.5' x 7.5'	16.6 179	—	—	—	—	8	—	—

Second Floor

MARLBOROUGH	11.7m x 5.6m x 2.4m 38.4' x 18.4' x 7.9'	65.5 706	64	45	30	30	60	80	40
BLenheim	7.7m x 7.4m x 2.4m 25.3' x 24.3' x 7.9'	57 615	70	40	20	20	50	60	32
SPENCER	6.5m x 7.2m x 2.3m 21.3' x 23.6' x 7.5'	46.8 503	60	35	20	30	50	60	32
RANDOLPH	6.5m x 7.5m x 2.3m 21.3' x 24.5' x 7.5'	48.7 522	32	24	16	18	40	40	16

HYATT REGENCY LONDON – THE CHURCHILL

30 Portman Square
London W1H 7BH
United Kingdom

T: +44 (0)20 7486 5800
F: +44 (0)20 7486 1255
E: london.churchill@hyatt.com
london.churchill.hyatt.com



FLOOR PLAN

Ground Floor

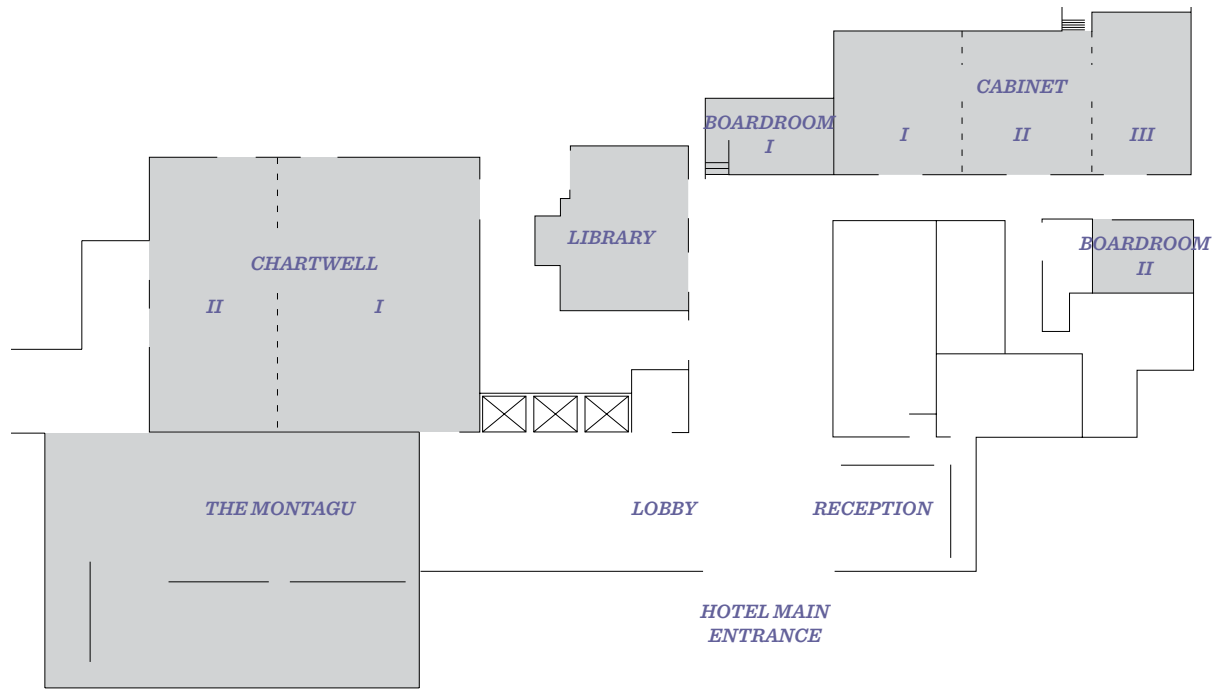

Second Floor

